



~1,500 sf

160/168 2 Avenue SW

~900 sf

110 1 Street SW

RETAIL SPACE FOR LEASE

Retail Podium in Riverpark 88

160/168 2 Avenue SW and 110 1 Street SW, Calgary

- » Brand-new development in Chinatown.
- » Prominent location directly across from the Chinese Cultural Centre.

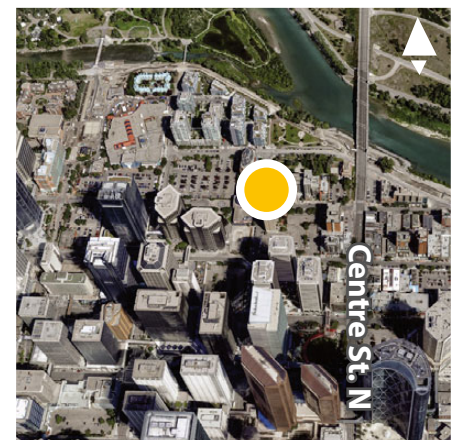

Andrew Sherbut, VICE PRESIDENT, PARTNER

C: 403-607-1819

O: 403-290-0178

asherbut@barclaystreet.com

Myles Scheske, SR. ASSOCIATE

C: 403-968-9859

O: 403-290-0178

mscheske@barclaystreet.com



TCN
WORLDWIDE
REAL ESTATE SERVICES

LOCAL
EXPERTISE
MATTERS

AREA DEMOGRAPHICS

(1 km radius)



Population
17,821



Median Age
37.2



Average Household Income **\$149,562**

Current Consumption / Household



\$14,966
FOOD



\$5,757
HEALTH CARE



\$4,934
RECREATION



\$2,246
PERSONAL CARE



\$5,176
LIQUOR/TOBACCO



\$3,747
CLOTHING



Daytime Employment

101,924
EMPLOYEES

3,441
BUSINESSES



Traffic Count
2018

5,000 VPD ON 1 STREET SW

6,000 VPD ON 2 AVENUE SW

Sources: Statistics Canada, City of Calgary, CoStar

- » Easily accessible from 1st Street SW and Centre Street, with direct routes to downtown and the Beltline.
- » Surrounded by numerous residential towers.
- » Steady foot traffic from river paths and the downtown core.
- » Strong daytime population of residents, office workers, and Chinatown visitors.

LEASE INFORMATION

ADDRESS: 168 2 Avenue SW, Calgary

AVAILABLE FOR LEASE:

~1,500 sq. ft. – 160/168 2 Avenue SW (corner unit)

~900 sq. ft. – 110 1 Street SW

AVAILABILITY: Available immediately for fixturing

OP. COSTS AND TAXES: \$15.00 per sq. ft. (est.)

NET RENT: Market rates

1 S T R E E T S W

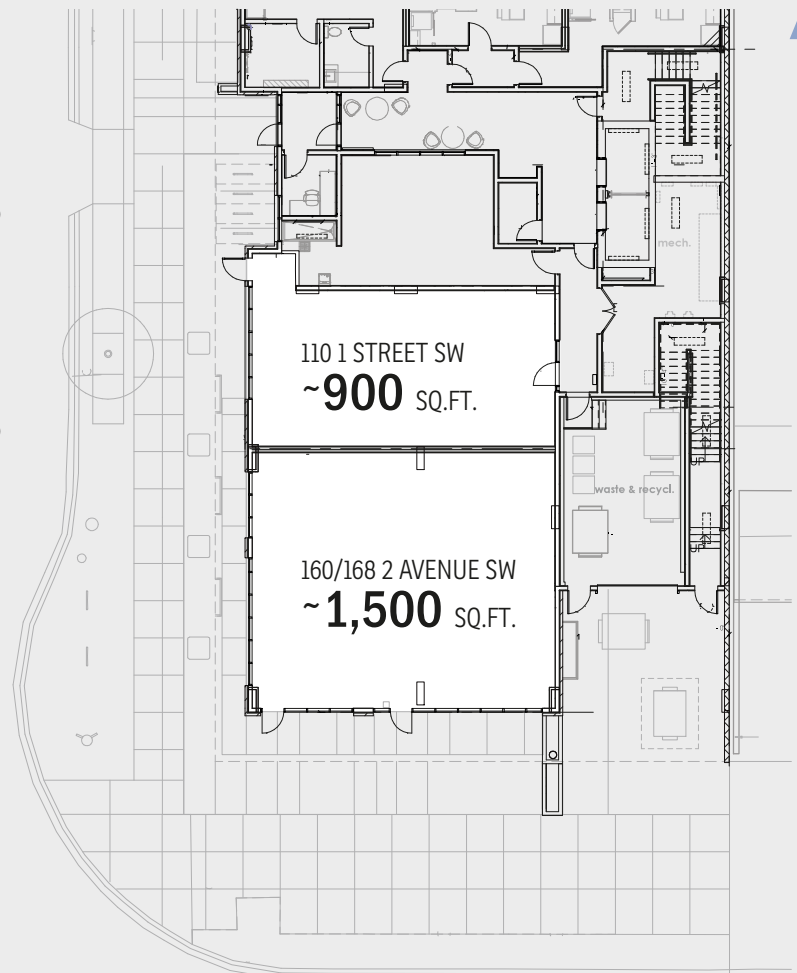

2 N D A V E N U E S W

160/168 2 AVENUE SW
~**1,500** SQ.FT.



110 1 STREET SW
~900 SQ.FT.



The information contained herein has been gathered from sources deemed reliable, but is not warranted as such and does not form any part of any future contract. This offering may be altered or withdrawn at any time without notice.

Copyright © 2025 Barclay Street Real Estate Ltd. All rights reserved.

