

± 1,000 sf

Unit 627 C/L

± 1,122 sf

Unit 631 C/L

2,122 SF



## RETAIL SPACE FOR LEASE

### Shawcliffe Gate

627 & 631 Shawcliffe Gate SW,  
Calgary

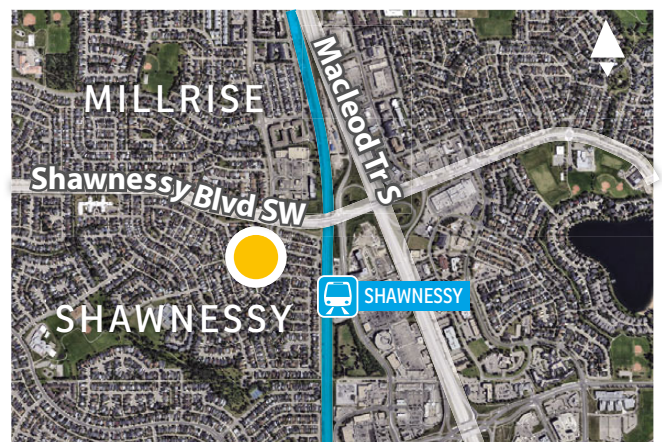

FOR MORE  
INFORMATION OR  
TO VIEW, PLEASE  
CONTACT:

**Joshua Gill**, SENIOR ASSOCIATE

C: 587-500-7707

O: 403-290-0178

jgill@barclaystreet.com



**TCN**  
WORLDWIDE  
REAL ESTATE SERVICES

LOCAL  
EXPERTISE  
MATTERS

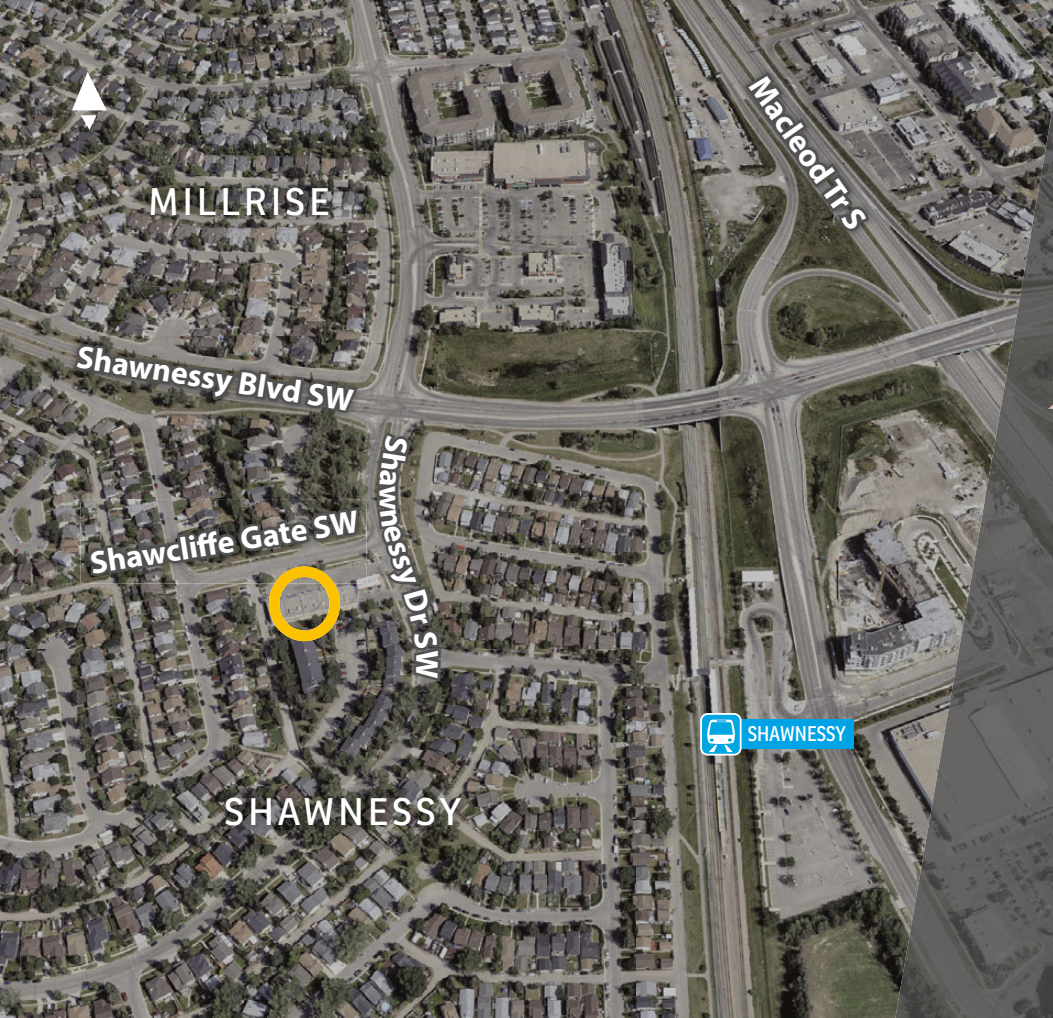

## Area Demographics

(1.5 km radius)



Population  
22,363



Median Age  
42.5



Average Household Income \$122,099



Current Consumption / Person



\$14,748  
FOOD



\$5,566  
HEALTH CARE



\$4,607  
RECREATION



\$2,016  
PERSONAL CARE



\$3,422  
LIQUOR/TOBACCO



\$3,465  
CLOTHING

Source: Statistics Canada

- » Neighborhood shopping centre serving community of Shawnessy and area.
- » Anchored by Petro Canada & 7-Eleven.

## LEASE INFORMATION

### ADDRESS:

627 & 631 Shawcliff Gate SW, Calgary

### COMMUNITY:

Shawnessy

### ZONING:

C-N2 (Commercial - Neighbourhood 2)

### AVAILABLE FOR LEASE:

±1,000 sq. ft. – Unit 627 **C/L**  
±1,122 sq. ft. – Unit 631 **C/L** 2,122 sq. ft.

### OP. COSTS AND TAXES:

\$18.91 per sq. ft. (est.)

NET RENT: Market



UNIT 631 **C/L**  
± 1,122 SQ.FT.

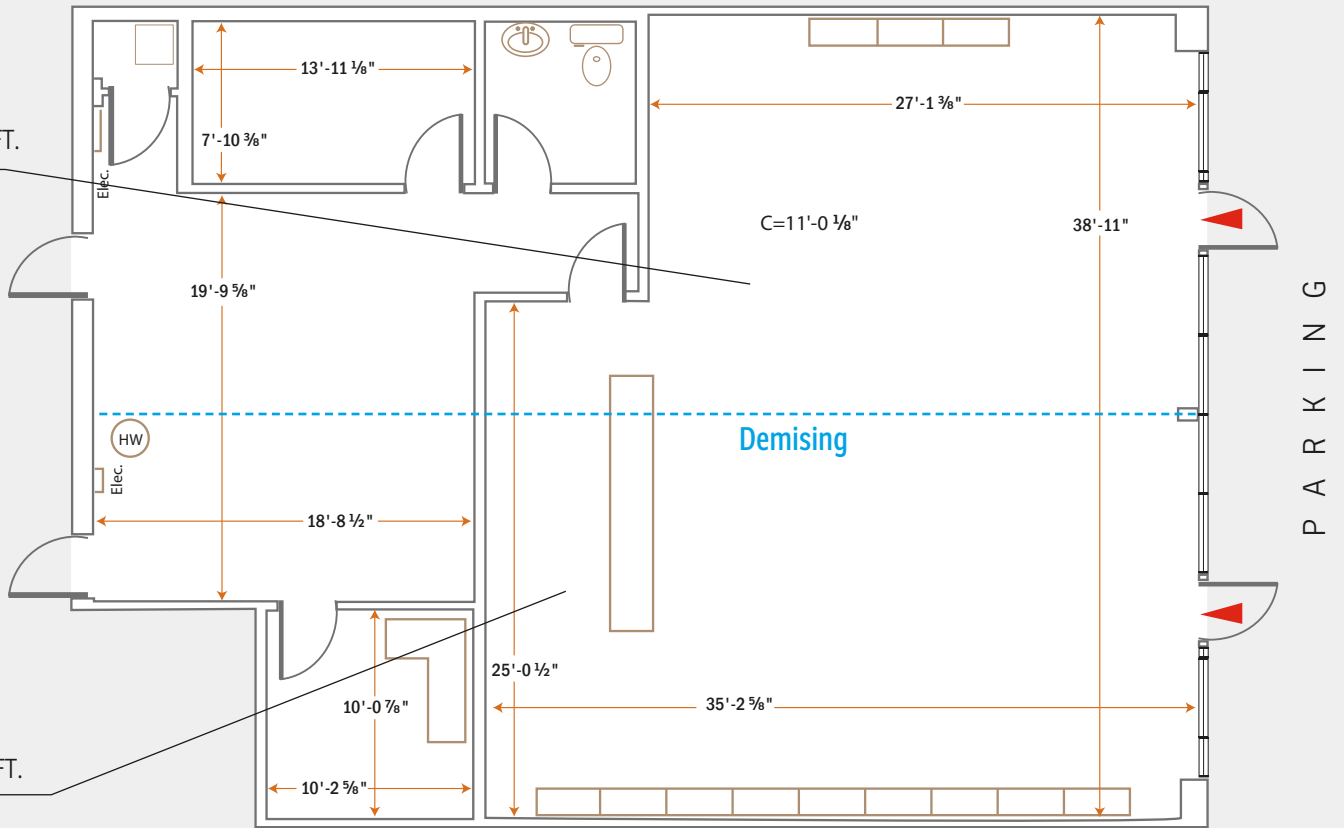

UNIT 627 **C/L**  
± 1,000 SQ.FT.





The information contained herein has been gathered from sources deemed reliable, but is not warranted as such and does not form any part of any future contract. This offering may be altered or withdrawn at any time without notice.

Copyright © 2025 Barclay Street Real Estate Ltd. All rights reserved.

